

S106 S116



DESCRIPTION

- . Zinc alloy die cast housing and cylinder.
- . Bright chrome plated standard.
- . 4 pin tumbler mechanism.
- . Zinc alloy tubular keys, chrome plated.
- . Key may be withdrawn in one or both positions.
- . Silver plated contacts and terminals.
- . S106 2 position (off-on) 2 terminals.
- . S116 2 position (on-on) 4 terminals.
- . Hex nut mounted.
- . All keyed alike or one combination per 100pcs standard.
- . 200 combinations available.

Unit: mm

Recommended hole size

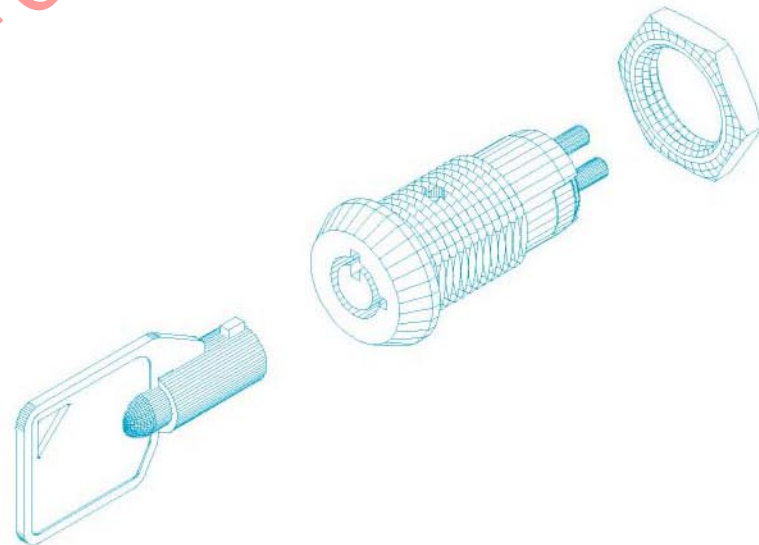
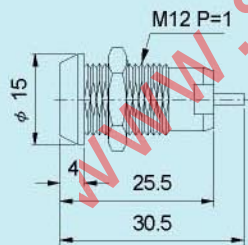
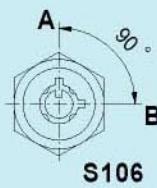
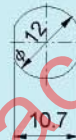
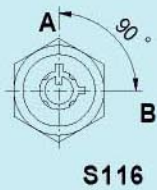

○ -OFF POSITION

■ -INDICATES KEY-PULL

● -INDICATES NO KEY-PULL



Fig No	Lock Number	Pole	Positions	Terminals	Key Pulls	Turn	↑	→	Type
1	S106-1	1	2	2	1	90°	Off	On	SPST
2	S106-2	1	2	2	2	90°	Off	On	SPST
3	S116-1	1	2	4	1	90°	On	On	SPDT
4	S116-2	1	2	4	2	90°	On	On	SPDT